



So the red will pop against the white behind it, dab your paintbrush on newspaper before painting the top of each letter so that the paint is not too wet. You only want to cover the top, flat surface. A flat brush works best for this. Paint lightly here, just a thin coat or two.



Before you glue, test fit the letters on the roof again. Pick letters up one at a time, use an old brush to apply glue onto the bottom of each one, and put it back exactly where it was as you go. Once they're all in place, take a look and adjust placement before the glue dries – you have just a few minutes. School glue is water soluble, but it destroys brushes once it dries, so I use dollar store brushes for glue.



Using a medium round pointed brush, not too full of paint, start with the white. Direction arrows, menu boards and "TIP" on a jar on the drive through shelf (which is a cut down coffee stirrer, glued on). Paint even, straight lines and move the model with your other hand for better control.

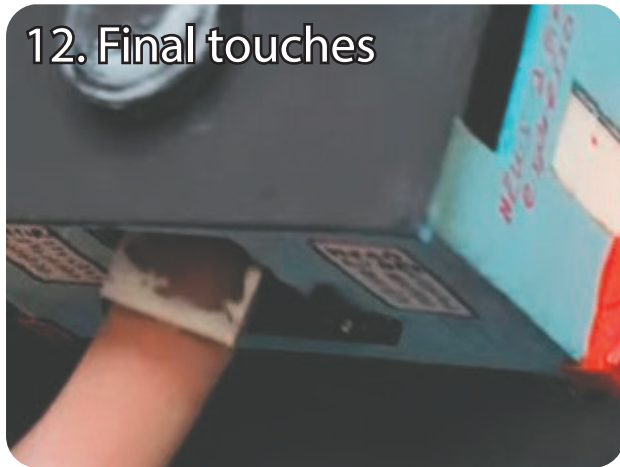

Paint a milk pull lid black and glue it to the roof for a roof vent. Use black and red markers to finish the menu boards, ORDER HERE over the window, and dots for doorknobs. Glue the edges of clear plastic (from a Hot Wheels package) and carefully push it into the back for the windows. Dry brush the roof vent gray. Touch up paint everywhere.



Happy Tree Village has a new spot to grab coffee and a paper. In case you were wondering, the back is nearly the same as the front. Find a place for it and make vroom-vroom sounds with your cars and figures.

What would you like to see next in Crafty Time? Visit www.craftytimewithdave.com for more photos and project ideas. Please email your feedback to dave@masoncounty.com or call 360-426-4412. Visit the Shelton-Mason County Journal office at 3rd & Cota to see the window display.

